



10 Elm View

, BA3 2QF

£1,400 Per Calendar Month

A recently renovated home located in the heart of Midsomer Norton and offered to the market for a long term let.

Available 13th May

Large living space

Modern kitchen

Central Midsomer Norton

Walking distance to High Street

Driveway and gardens

Viewing

Please contact our Bath Stone Property Office on 01225422224 if you wish to arrange a viewing appointment for this property or require further information.



3



1



1



C

Floor Plan

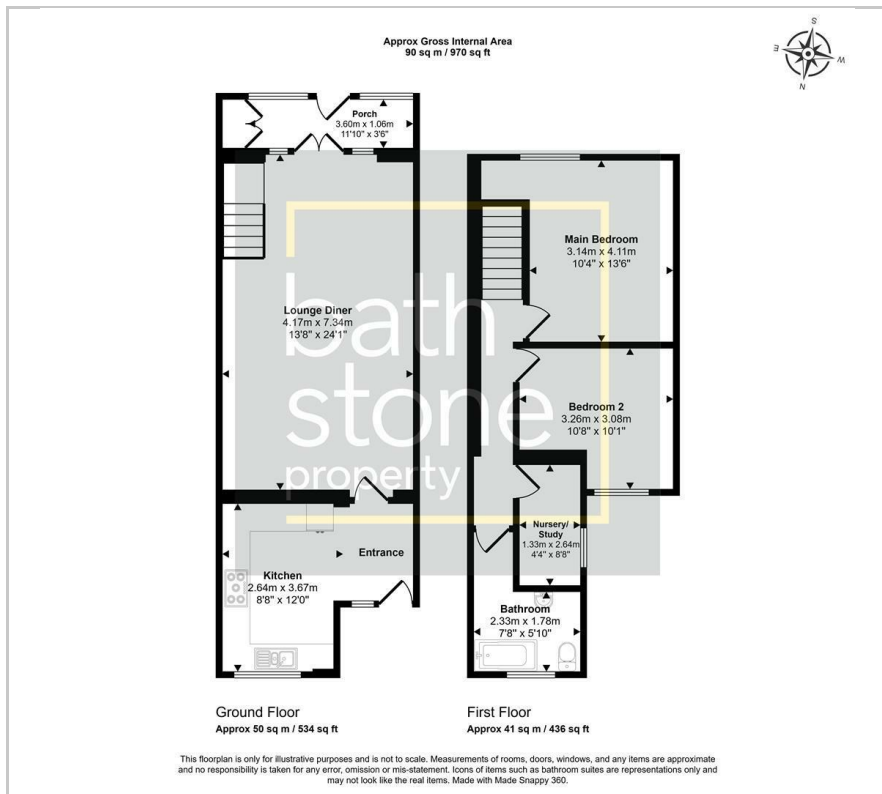

Energy Efficiency Graph

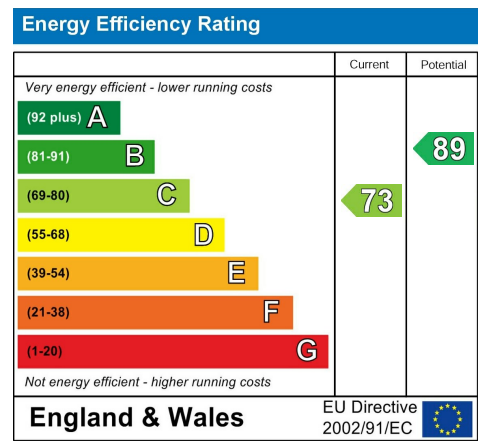

Please give us Feedback



These particulars, whilst believed to be accurate are set out as a general outline only for guidance and do not constitute any part of an offer or contract. Intending purchasers should not rely on them as statements of representation of fact, but must satisfy themselves by inspection or otherwise as to their accuracy. No person in this firm's employment has the authority to make or give any representation or warranty in respect of the property.